

RC200

IntelliFire Plus™ Multifunction Remote Control

Installation & Operating Instructions

Hearth & Home Technologies disclaims any responsibility for, and the warranty will be voided by, the following actions:

- Installation and use of any damaged system component.
- Modification of the system component.
- Installation other than as instructed by Hearth & Home Technologies.
- Installation and/or use of any component part not approved by Hearth & Home Technologies.

Any such action may cause a fire hazard.

- Read, understand and follow these instructions for safe installation and operation.

Introduction

The RC200 multifunctional wireless control with docking station is designed to control constant pilot feature, flame height, blower speed and to turn your gas fireplace on and off. The RC200 remote control is only for use with the Hearth & Home Technologies IntelliFire Plus™ system (IPI).

FCC Requirements

WARNING! Risk of Fire! Changes or modifications to this unit not expressly approved by the party responsible for compliance could void the user's authority to operate the equipment.

Note: This equipment has been tested and found to comply with the limits for a Class B digital device, pursuant to Part 15 of the FCC Rules. These limits are designed to provide reasonable protection against harmful interference in a residential installation. This equipment generates, uses, and can radiate radio frequency energy and, if not installed and used in accordance with the instructions, may cause harmful interference to radio communications. However, there is no guarantee that interference will not occur in a particular installation. If this equipment does cause harmful interference to radio or television reception, which can be determined by turning the equipment off and on, the user is encouraged to try to correct the interference by one or more of the following measures:

- Reorient or relocate the receiving antenna.
- Increase the separation between the equipment and receiver.
- Connect the equipment into an outlet on a circuit different from that to which the receiver is connected.
- Contact the dealer or an experienced radio TV technician for help.

Canadian Equipment Requirements

This digital apparatus does not exceed the (Class A/ Class B) limits for radio noise emissions from digital apparatus set out in the Radio Interference Regulations of the Canadian Department of Communications. Le present appareil numerique n'emet pas de bruits radioelectriques depassant les limites applicables aux appareils numeriques (de la class A/de la class B) prescrites dans le Reglement sur le brouillage radioelectrique edicte par le ministere des Communications du Canada.

This device complies with RSS-210 of Industry and Science Canada. Operation is subject to the following two conditions: (1) this device may not cause interference, and (2) this device must accept any interference, including interference that may cause undesired operation of the device.

Installation Precautions

This control is tested and safe when installed in accordance with this installation manual. Do not install any components that may be damaged.

Do not modify, disassemble, or substitute any of the components included with this kit. Installation of this unit must be done by a qualified service technician.

Placement of this remote control may affect performance. An assessment of the space should be done prior to installation for optimum performance.

Determine Location

Determine the location for the remote control. The selected location should be in the same space as the gas fireplace with visual sight of fireplace. The remote control must be placed within 30 feet of the fireplace but should not be exposed to extreme heat.

The RC200 is approved for interior installation and should always be placed under weather resistant cover when used in exterior applications.

- Keep remote control out of reach of children.

Installation of Remote Control Housing

CAUTION! Risk of Fire! DO NOT install damaged or modified components. Warranty will be voided if damaged or modified components are installed.

Kit components: One remote control, two #6 screws, two wall anchors, one A23 battery and one AUX200 module (if purchased retail).

1. Remove remote control components from packaging.
2. Remove battery cover from the back of the remote by sliding it down and install A23 battery.

To prevent unintended operation when not using your fireplace for an extended period of time (summer months, vacation, trips, etc):

- Remove battery from remote control.
 - Unplug switching adapter and remove back-up batteries.
3. Secure the remote control housing on a flat wall surface using the two screws and wall anchors provided. See Figure 1.

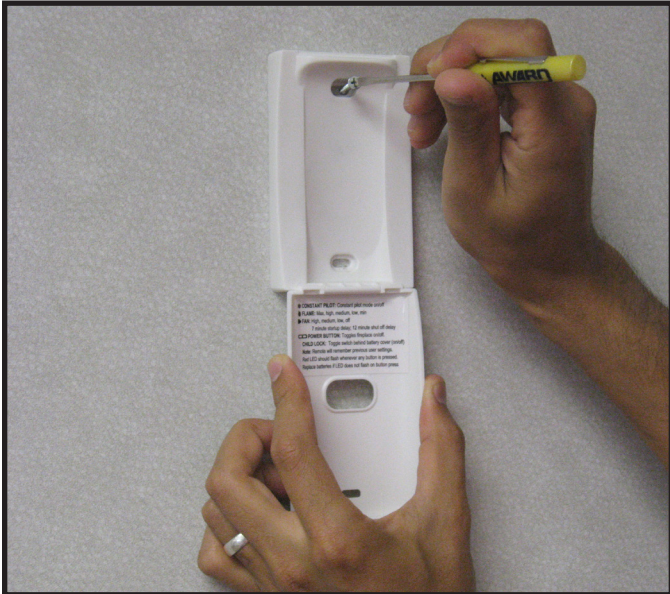

Figure 1. Mounting Remote Control Housing

4. Place remote control inside housing. See Figure 2.



Figure 2. Remote in Housing

5. Close the housing door and press the power button. The red light illuminates if the battery was properly installed. See Figure 3.



Figure 3. Mounting Remote Control Housing

AUX200 Module Installation

- Control Module should be set in the OFF position before any components are installed.
- Insert the 4 hole harness from the AUX200 module into the 4 pin plug on the control module. See Figure 4.

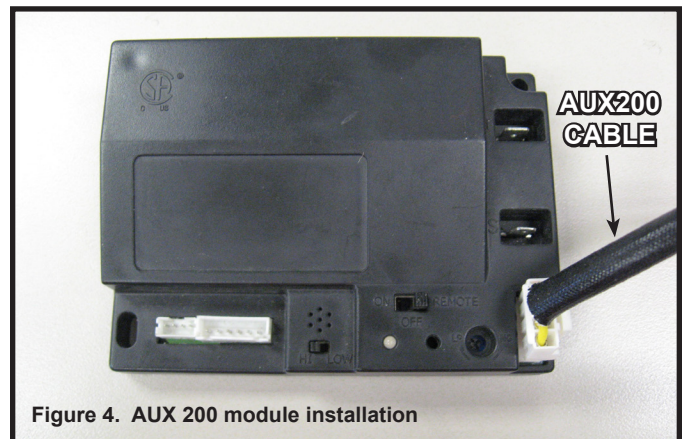

Figure 4. AUX 200 module installation

Fan Installation

- Insert the 3 prong plug from the fan into the receptacle located in the AUX200 module. See Figure 5.

- Insert 3 prong plug from AUX200 module into REM/AUX receptacle of fireplace junction box.

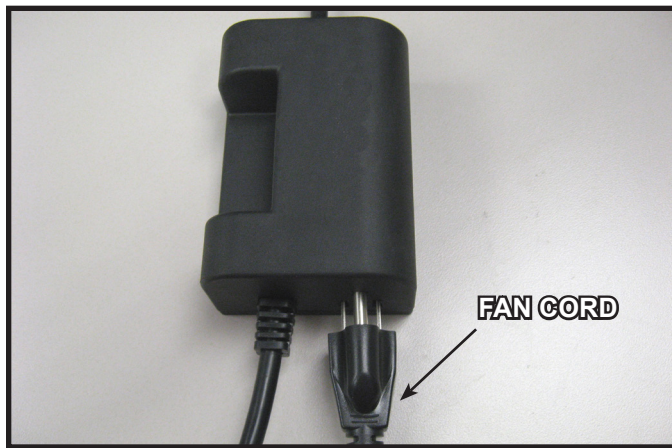

Figure 5. Plug Fan into AUX200 Module

Programming the RC200 to the Control Module

CAUTION! Risk of burns! DO NOT program the remote control to the control module when fireplace is hot.

- Verify the ON/OFF/REMOTE switch is in the REMOTE position. Green LED light will blink three times and beep once 5 seconds later when ready. See Figure 6.
- Using a small item (such as a paper clip) press and release the learn button located near the ON/OFF/REMOTE switch. See Figure 6.
- Control module will beep once and LED will blink green for 10 seconds.
- While the LED is blinking, press the power button on the remote control. A double beep will come out of the control module to indicate that it has been programmed successfully.

NOTICE: Up to three remote controls can be programmed into the control module. Simply press a button on the other remote controls during the 10 second programming process to add another remote into the system.

To clear memory in the control module, use a small item (such as a paper clip) to press and release the LEARN button. Control module will beep once and LED will blink green for 10 seconds **DO NOT** press any buttons on the remote during the ten seconds that the green LED blinks. The memory will be cleared.

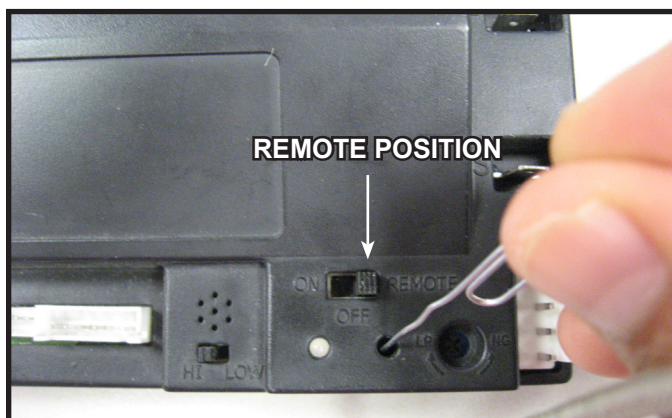

Figure 6. Programming RC200

Function Buttons



Press the POWER button to turn the fireplace ON and OFF. The fireplace will first ignite the pilot. Once the pilot flame is established the main burner will be lit.



Press the FLAME button to adjust the flame height. The flame height can be adjusted to 5 different settings: MAX, HIGH, MEDIUM, LOW, MIN. Flame height will not be adjustable for first ten seconds when fireplace is turned on. The system remembers the previous flame height setting and will automatically adjust to previous setting after 10 seconds.

NOTICE: Whenever the fireplace is cycled from OFF to ON, the main burner will light on high for 10 seconds before returning to the previous user setting.



Press the FAN button to adjust the fan speed. The FAN speed can be adjusted to 4 different settings: HIGH, MED, LOW and OFF. The fan has a timer built into the control module. After the fireplace is turned ON the timer will wait for 3 minutes before turning on the fan. In addition, the fan will remain on for 12 minutes after the fireplace has been turned OFF. Whenever the fan is turned ON, the FAN will start up on the high setting for 10 seconds before adjusting to the previous user setting.



Press the PILOT button to activate or deactivate the constant pilot. The control module will beep once indicating constant pilot has been activated. A double beep indicates the constant pilot has been deactivated.

NOTICE: The constant pilot will automatically turn OFF after 166 hours if appliance is not actively used. If Flame ON is activated before 166 hours, the automatic timer will re-start.

Setting the Child Lock

- Remove battery cover from the back of the remote by sliding it down. Slide the child lock switch to enable or disable the child lock feature. See Figure 7.

NOTICE: No functions will be usable until child lock feature is disabled.

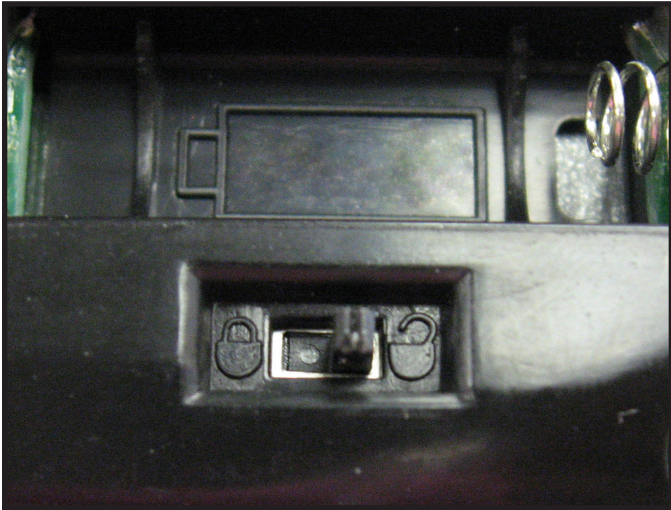

Figure 7. Child Lock Switch

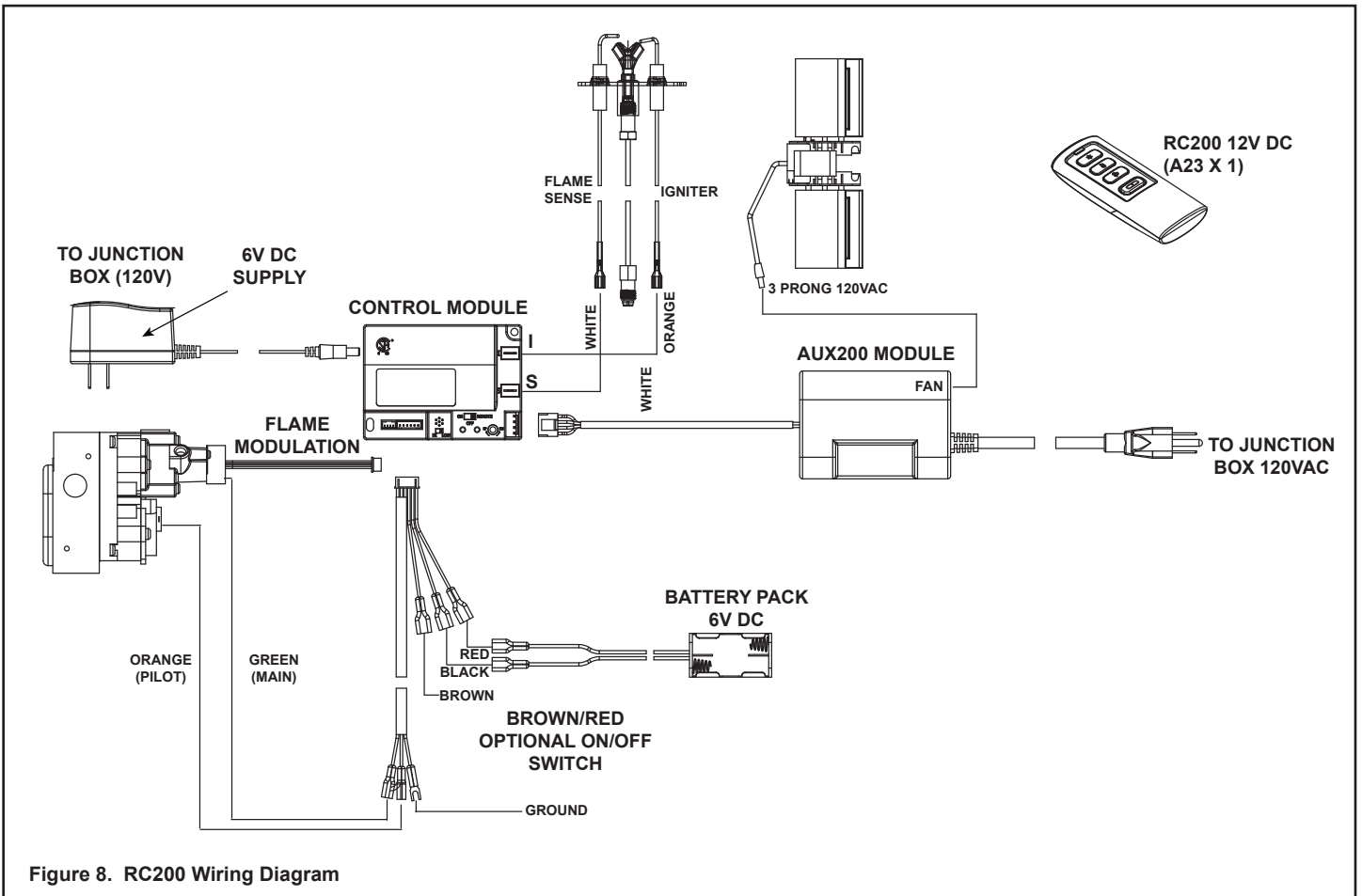

Figure 8. RC200 Wiring Diagram

Power Outage

- If fireplace battery backup system IS installed at time of power outage, fireplace operation will not be interrupted.
- If fireplace battery backup system IS NOT installed at time of power outage, fireplace will shut off. To resume fireplace operation, install battery backup.

NOTICE: Battery polarity must be correct or module damage will occur.

Manual Fireplace Shutoff

In the unlikely event that the remote wall switch malfunctions and will not turn off the fireplace, call your dealer for service assistance. In the meantime, you may choose one of the following actions to turn off the fireplace:

CAUTION! Risk of burns! Fireplace surfaces are hot when operating and during cool down. Use care and wear gloves when opening the front and accessing components inside the fireplace.

The fireplace may be manually shut down by one of the following methods:

Turn off the control module:

- Open or remove the decorative front to access the control module.
- Move switch to OFF (See Figure 6).

Disconnect power to the control module:

- Open or remove the decorative front to access power cord to the junction box and/or back-up batteries.
- Unplug the control module and/or remove back-up batteries.

Shut off gas to the control:

- Open or remove the decorative front and locate the gas shut-off valve to the left of the gas control.
- Rotate the valve 90 degrees to turn off gas supply.

Turn off power to the fireplace (if back-up batteries are not installed):

- Locate house circuit breaker for fireplace.
- Turn off the circuit breaker.

Frequently Asked Questions/Troubleshooting

Symptom	Possible Cause	Corrective Action
Remote control will not transmit	Batteries	Verify battery is functional and installed correctly.
	Remote control is in Child Lock mode	Disengage Child Lock mode.
Control module will not take commands from remote control	Control module is not in "REMOTE" mode	Ensure module switch is set to REMOTE.
	Control module and remote control are not programmed to each other	The control module will beep when it successfully receives a command. If it does not beep, clear module memory and re-program wall switch.
	Control module is unplugged. In case of power outage, backup batteries are depleted or missing	If red LED light comes on when power button is pressed, verify that the control module is plugged in the fireplace junction box located in the controls area. Also verify that the batteries are installed in the battery pack.
Fan does not turn on when fireplace is started	Built in time delay	The fireplace must run for three minutes in order for the fan to engage.
Fan does not turn off when fireplace turned off	Built in time delay	The fan will run for twelve minutes after the fireplace is turned off.
Fireplace shuts down after extended periods	Built-in timer	The fireplace will automatically shut down after nine hours of continuous operation if it does not receive a command from the remote.
Fireplace is on but will not shut off with the remote control	External wired wall switch	The fireplace cannot be turned off by remote if an external wired wall switch is installed and in the ON position. Turn external wall switch to OFF.
	Remote control or control module failure	At control module, turn off fireplace by sliding the ON/OFF/REMOTE switch to OFF. Warning! Risk of Fire! Fireplace is hot. Use caution when accessing module.

Please contact your Hearth & Home Technologies dealer with any questions or concerns.
For the location of your nearest
Hearth & Home Technologies dealer,
please visit www.fireside.com.